

Magnet

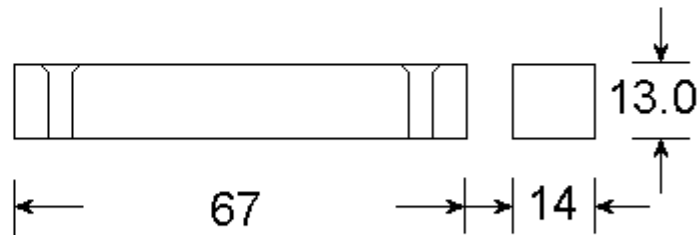
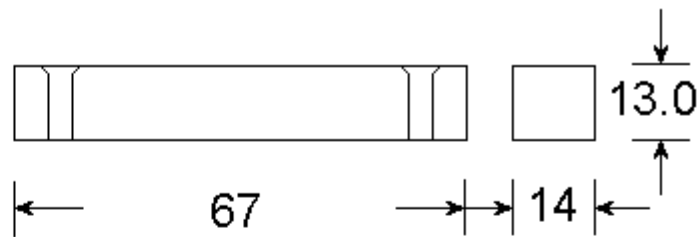

**Description:**  
5 Terminal Contact  
Single Reed

**Operating Gap:**  
20mm (Approx)

**Materials:**  
High Impact Polystyrene  
Stainless Steel Plate

**Magnet:**  
Ferrite or Alnico V

**Contact Material:**  
Rhodium

**Voltage Range:**  
1 – 100v DC  
125v AC Max

**Switching Current**  
500mA Max DC  
500mA Max AC

**Temperature Range:**  
-40°C - +50°C

Fixing Screws Provided

All units in mm  
Do not scale

