

Sanipull Cleanable Replacement Anti Ligature Ribbon

S300AL-O, S300AL-R, S300AL-W

With over 20,000 customers around the world, Sanipull cleanable, replacement pull cords are the product of choice for NHS hospitals, schools and local authority washrooms and toilets. Wherever lighting, nurse call and disabled assistance alarms are fitted with a traditional string pull, Sanipull can provide the most cost-effective replacement, backed by a manufacturer's 5 year warranty.

Available in standard, or anti-ligature ribbon in a choice of colours, SaniPull is the only product to provide a sanitary touch point for pull cords in any facility.

Traditional Pull Cord Problems

Traditional string pulls harbour a myriad of bacteria deep in the woven fibres and are notoriously difficult to clean and sanitize. Often installed in washrooms, faecal matter and urine are spread by poor hand hygiene practice and the resultant bacteria multiply within the weave. Sanipull removes this problem. Manufactured from tough and durable vinyl, Sanipull cords are sanitized easily by spraying and wiping, leaving the surface free from pathogens.

Simple to install in less than 40 seconds, the clamshell is designed to clip directly to traditional string pulls, or directly to ceiling fittings as shown opposite.

In the UK, Sanipull is available in traditional colours of white, orange and red to comply with current legislation. Other colours are available to comply with international legislation.

Full details of the Sanipull products can be found on our website.

**Anti-Ligature Specification**

Hoyles Sanipull ribbons are available with anti-ligature patient safety breakaway protection designed to break apart at a weak zone when a force of $13\text{Kg} \pm 1\text{Kg}$. Is applied to the ribbon. The ribbon is manufactured with a series of 8mm holes every 15cm along its length to achieve this safety precaution. This modification results in the anti-ligature versions not being as durable as the standard product therefore our warranty only extends to the component fittings. Please note that we will not be held liable for death or damages directly or indirectly involving a sanipull product.

Please remember that for nurse call pulls, to comply with legislation you must have 1 bangle 100mm from the floor and another bangle at a height of 1 metre from the floor.

Instead of purchasing individual Sanipull cords, for large facilities with a high number of nurse call or lighting pulls you have the option of purchasing the ribbon in 300 metre reels, so that you can make them exactly to the correct length. You then simply add the number of bangles and clamshells you require to make up your Sanipull.

Please contact us for further details on bulk purchasing of Sanipull products.



Sanipull Cleanable Replacement Anti Ligature Ribbon

S300AL-O, S300AL-R, S300AL-W

Assembly of Sanipull Pull Cords

Once fitted the S300CLAM is not designed to be tampered with, If the cord needs to be replaced or moved, then a new clam should be used.

In order to make up your Sanipull pull cords you will need the following:

- 1 x Bandage Scissors to cut the ribbon to the required length.
- 1 x Pair of Sanitary Gloves
- 1 x Tape measure.
- 1 x Reel of Anti Ligature Sanipull Ribbon
- Required number of Clamshells (for ceiling fixing)
- Required number of Bangles (grasp handles)

Assembly Procedure

Withdraw from the bulk spool or coil sufficient Sanipull ribbon and cut to the optimum length. From the direction of the middle of the adapter insert the ribbon end under the plastic bridge found in the lower clamshell (look for guide arrows). Fold the ribbon back toward the adapter's bottom end. Close the lower clamshell door.

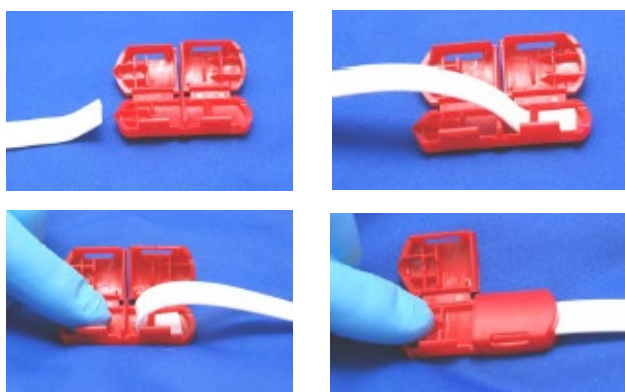

You can connect the completed clamshell to any type of ceiling fixture, either directly to the fixture or by means of the existing string pull close to the fixture as can be seen below. If attaching to a string pull, tie a knot in the end of the string and insert into the clamshell and close the door to secure. You may choose to use a small 3mm washer to prevent pull through if the pull cord will be subject to misuse.

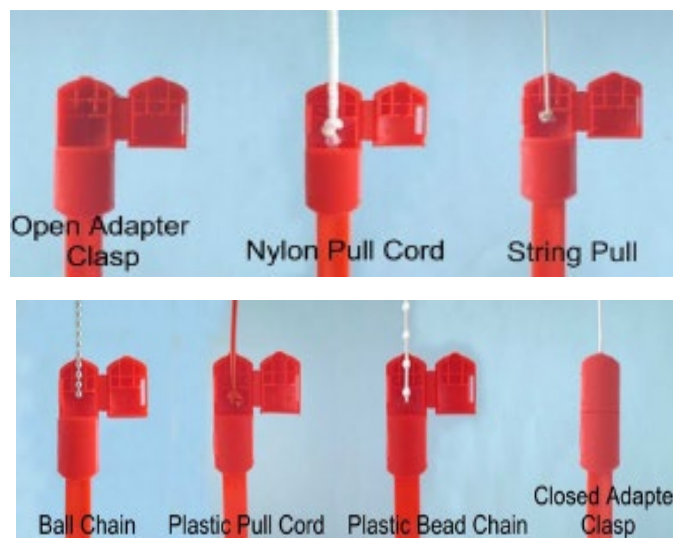

The next stage is to attach the bangle to the ribbon. The bangles are available in 2 types, open and closed as shown in the diagram below. The bangle can be fitted along any point of the ribbon. Simply slide on the cover and then thread the ribbon through the bangle teeth. Slide the cover over the teeth and the bangle will be secured at any point along the ribbon.

